

Finnlife® Log cabins

Parts lists and plans

Model: 114445 / 135350



A.0 introduction

The information and instructions in this document are specific to the 114445 / 135350 Log Cabin. Please read them in conjunction with your General Instruction Manual.

The instructions in your general manual cover a wide range of Finnlife® log cabins. Not all of those instructions relate to your log cabin. For a complete sequence of instruction references for the 114445 / 135350 Log Cabin (numeric from 1.0 to 28.0 in the General Instruction Manual – and alphabetic from A.0 to F.0 in this Building Plans and Parts List), refer to section C.0.

NB: ONLY INSTRUCTION REFERENCES LISTED IN THE SEQUENCE IN SECTION C.0 APPLY TO YOUR LOG CABIN. IGNORE ALL OTHER INSTRUCTIONS.

Please read both documents thoroughly before you start building.



This icon refers to model variations and model specific information. It appears throughout the general instruction manual. When it appears you may need to then refer to this manual.

B.0 contents

	Instruction Reference	Page Number
Complete sequence of building instructions	C.0	3
Canopy support pillar construction	D.0	4
Parts list	E.0	9
Building plans	F.0	13

C.0 complete sequence of building instructions

To build your 114445 / 135350 Log Cabin you should follow the instructions in the order listed below. It may be helpful to run through the General Instruction Manual with a highlighter pen to mark the instructions that apply to your cabin.

Familiarisation	1.0 to 4.0; A.0 to C.0; 24.0 to 28.0; E.0
Preparation	5.0 to 7.2
Assembling double door frames	8.0 to 8.6
Starting out	F.0; 9.0 to 9.6; 10.0 to 10.7
Building up the walls	F.0; 11.0 to 14.4
Finishing the walls and roof beams	D.0; F.0; 15.0 to 15.3
Terrace	F.0; 23.0 to 23.18
Roof Boards & Shingles	F.0; 16.0 to 19.4
Interior Finishing	F.0; 20.0 to 22.2

D.0 canopy support pillar

You cannot complete the roof of your log cabin until you have installed the terrace and pillars that support the overhanging canopy. There are two types of support pillar: two shorter pillars that rest on the corners of the terrace rails, and a longer one that butts up to the terrace rail and which rests on the terrace floor:

D.1

Ensure that the terrace section of the cabin has been fully constructed, as the posts will be required to sit on top. Ensure that the surface of the terrace walls are clean and clear of any unnecessary debris as this could effect the fixing of the support posts.



D.2

Take an adjustable pillar bolt (part ref AH1) and wind the hexagonal nut all the way to the bottom. Do the same for the tee nut also. Then locate the adjustable pillar bolt in the hole in the top of one of the shorter support pillars (part ref PO2) with the thread part pointing upwards.

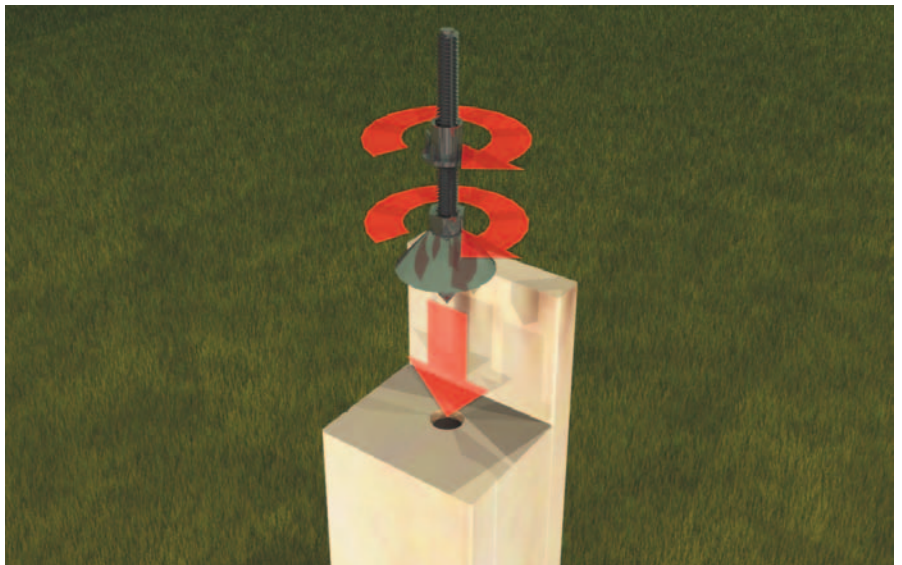

D.3

Slot your support post over the terrace then locate part (CY1) wall board and insert into the shorter support post, carefully locating the adjustable pillar bolt into the pre-drilled holes.

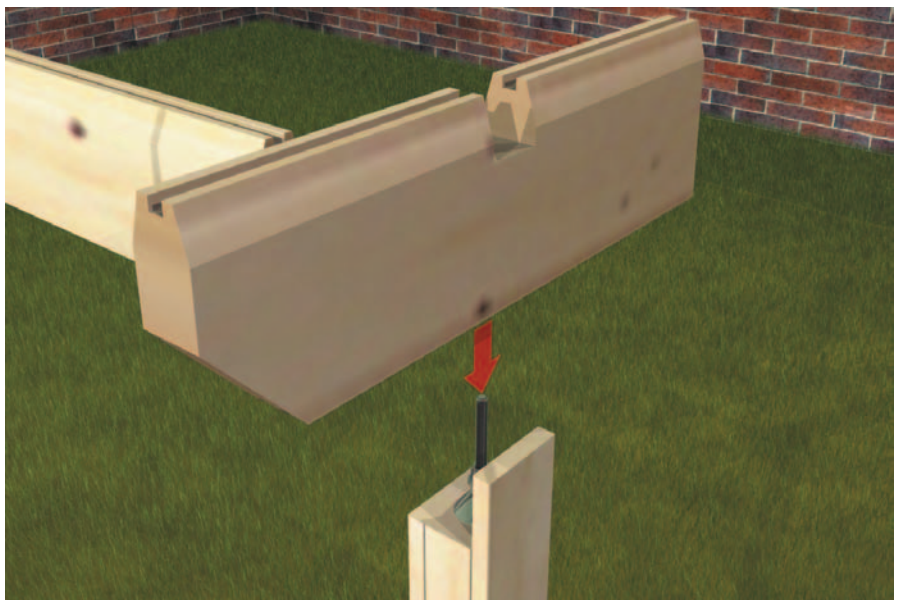

D.4

Now raise the top of the pillar with its linked pillar board so that the upper edge of the pillar board interlocks at right angles with the underside of the overhanging A5/C5 wall board. The pillar board should be aligned left-right with the front terrace rail.

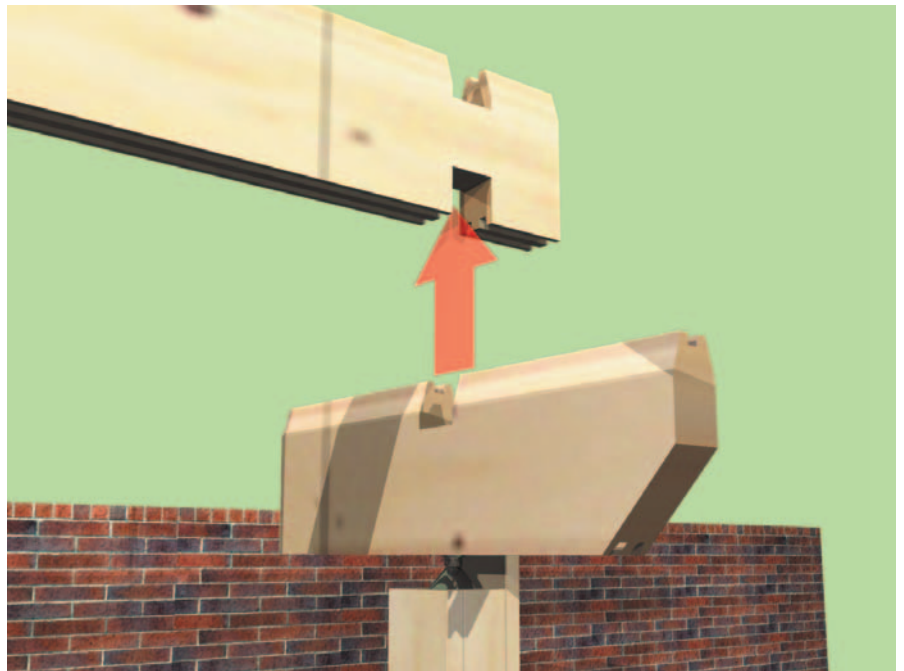

D.5

Once you have slotted the overhanging wall log (A5/C5) into the pillar boards. Fix using the screws provided.



D.6

Use a spanner to turn the nut on the pillar bolt upwards till the pillar support sits tightly in place. Do not raise the nut too high or the overhanging wall board will start to lift off the one below.



REPEAT SECTIONS 1 - 6 FOR THE OPPOSITE SIDE.

D.7

Slide the third pillar board (part ref PO1) into the recess at the top of the longer support pillar (part ref CY2). Make sure that the angled ends are at the bottom and the adjustable pillar bolts are connected correctly. Raise this support pillar so that the pillar board interlocks at right angles with the underside of the central overhanging E3 wall board. Locate the groove in the lower part of the pillar with the projecting end of the terrace boards. Press them together for a snug fit.

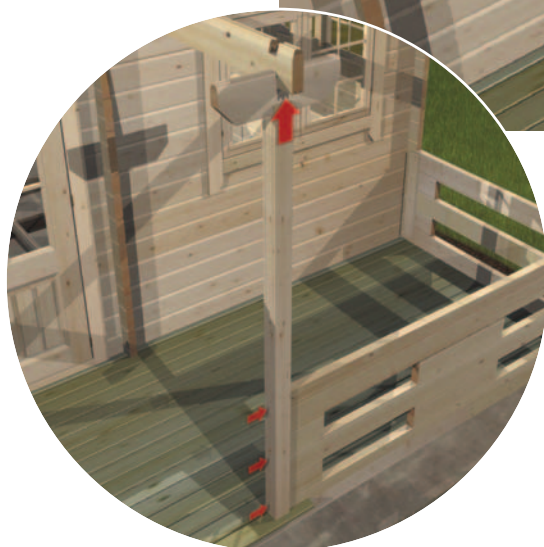

D.8

Slide the base of an angle iron bracket (part ref ABI) beneath the foot of the support pillar and slot the vertical arm into the groove in the exposed side of the pillar. Make sure the bracket sits squarely beneath the base of the pillar and that the pillar is vertical. Mark on the underlying deck boards where the angle iron bracket rests.

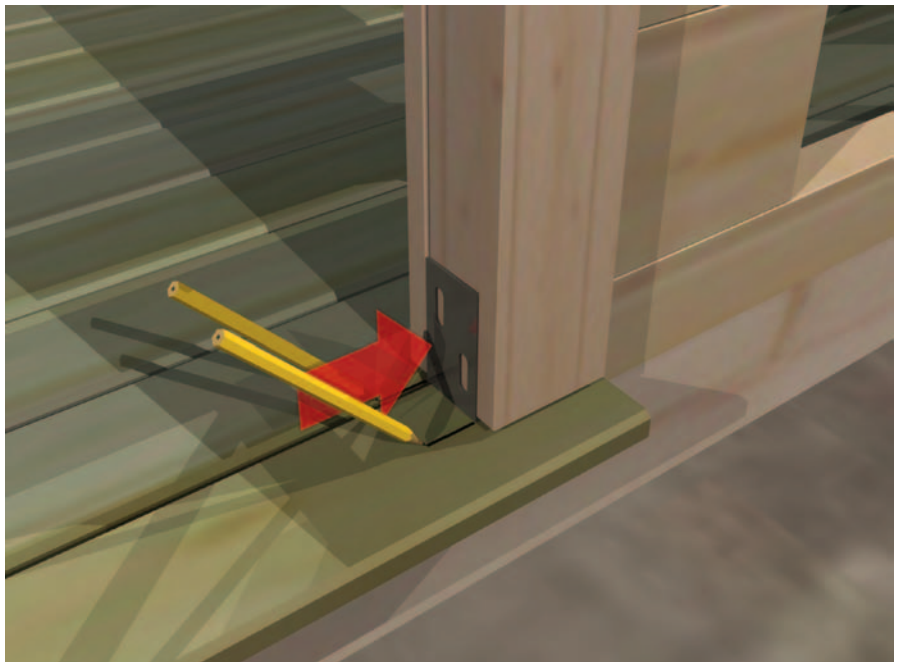

D.9

Temporarily ease the base of the support pillar away. Remove the angle iron bracket, align it within the marks you drew on the deck boards and then screw it down.

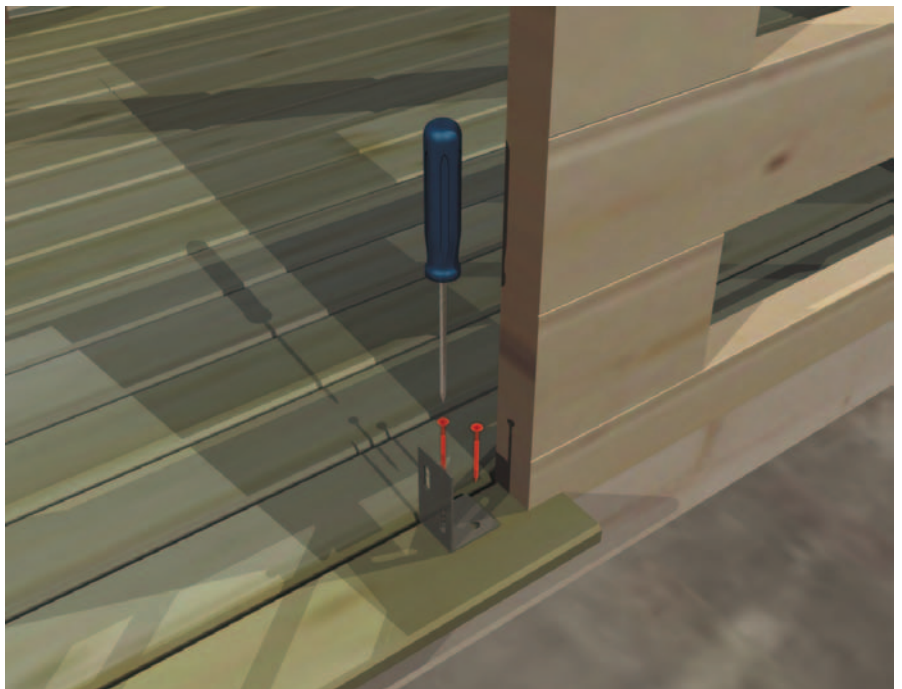

D.10 Ease the support pillar back into place, then screw the foot to the angle bracket.

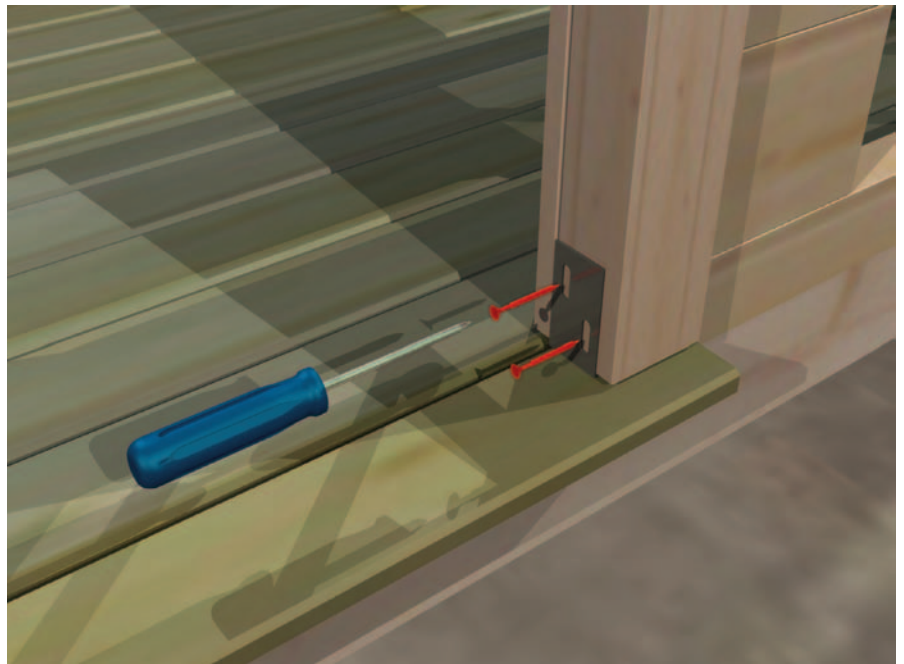

D.11 Continue canopy construction by interlocking the long front wall board with the three projecting wall boards and the underlying pillar boards.

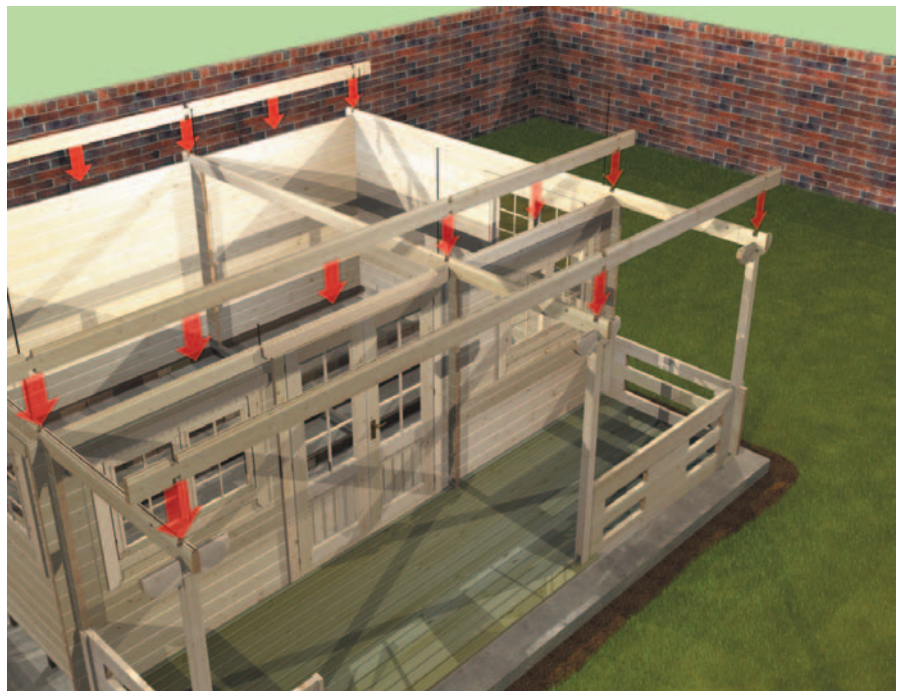

E.0 parts list

The following is a complete list of components, including screws and nails, for your cabin. A unique part reference number identifies each type of component; identical components use the same part reference. You should refer to this list when you perform your initial component check-off (see section 7.0) and during construction when you need to identify specific components. All dimensions are in millimetres (mm) and approximate.



Door (left hand)
DOI044: 1 of 780 x 1860mm
Measurements include frame



Door (right hand)
DOI044: 1 of 780 x 1860mm
Measurements include frame



Window, **WSI144**: 4 of 1190 x 790mm



Door jamb (head), **DJ1**: 1 of 55 x 65 x 1560mm



Door jamb (cill), **DJ2**: 1 of 55 x 65 x 1560mm



Door jamb (left), **DJ3**: 1 of 55 x 65 x 1760mm



Door jamb (right), **DJ4**: 1 of 55 x 65 x 1760mm



Beam cover board, **DBI**: 1 of 18 x 95 x 5728mm



Deckboard, **DB2**: 16 of 18 x 95 x 5633mm



Eaves fascia board, **EBI**: 4 of 16 x 95 x 3064mm



Floor beam (cabin), **FB2**: 16 of 50 x 100 x 2864mm



Floor beam (terrace), **FBI**: 10 of 50 x 100 x 1500mm



Floorboard, **FCI**: 70 of 18 x 95 x 3627mm

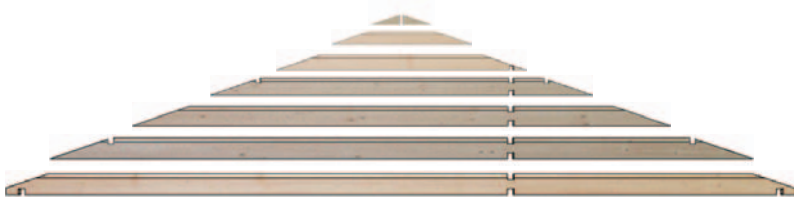

Gable board, **A12**: 2 of 44 x 95 x 291mm
Gable board, **A11**: 1 of 44 x 145 x 1456mm
Gable board, **A10**: 1 of 44 x 145 x 2180mm
Gable board, **A9**: 1 of 44 x 145 x 3118mm
Gable board, **A8**: 1 of 44 x 145 x 3919mm
Gable board, **A7**: 1 of 44 x 145 x 4780mm
Gable board, **A6**: 1 of 44 x 145 x 5394mm



Gable board, **C12**: 2 of 44 x 95 x 291mm
Gable board, **C11**: 1 of 44 x 145 x 1456mm
Gable board, **C10**: 1 of 44 x 145 x 2181mm
Gable board, **C9**: 1 of 44 x 145 x 3118mm
Gable board, **C8**: 1 of 44 x 145 x 3919mm
Gable board, **C7**: 1 of 44 x 145 x 4780mm
Gable board, **C6**: 1 of 44 x 145 x 5394mm



Gable board, **E10**: 2 of 44 x 95 x 291mm
Gable board, **E9**: 1 of 44 x 145 x 1456mm
Gable board, **E8**: 1 of 44 x 145 x 2180mm
Gable board, **E7**: 1 of 44 x 145 x 3118mm
Gable board, **E6**: 1 of 44 x 145 x 3919mm
Gable board, **E5**: 1 of 44 x 145 x 4780mm
Gable board, **E4**: 1 of 44 x 145 x 5394mm



Ridge beam, **P1**: 1 of 44 x 145 x 5900mm



Roof beam, **P2**: 2 of 44 x 145 x 5900mm



Roof board, **RB1**: 146 of 18 x 95 x 2933mm



Roof shingles, **RS6**: 336 of (16 packs)



Gable fascia board, **GF1**: 4 of 16 x 145 x 2960mm



Gable fascia cover board, **GF2**: 4 of 16 x 95 x 2960mm



Adjustable pillar bolt, **AH1**: 3 of M12



Angle iron bracket, **HAI**: 2 of



Storm batten fixings, **HB2**: 8 of M8 x 75mm Coach bolts and nuts
HWI: 8 of M8 x Washers



Gable diamond, **GDI**: 2 of



Nail, **HN2**: 2800 of 50mm



Nail, **HN3**: 1200 of 50mm



Roof tack, **HNI**: 1500 of 15mm



Screw, **HS5**: 16 of 3.5 x 25mm



Screw, **HS3**: 50 of 4 x 50mm



Screw, **HS1**: 20 of 5 x 100mm



Skirting board, **FD1**: 2 of 20 x 30 x 5700mm



Skirting board, **FD2**: 2 of 20 x 30 x 3900mm



Storm batten, **SBI**: 4 of 18 x 44 x 2700mm



Post, **PO2**: 2 of 44 x 69 x 1346mm



Post, **PO1**: 1 of 44 x 69 x 1944mm



Canopy board, **CY2**: 1 of 44 x 145 x 444mm



Canopy board, **CY1**: 2 of 44 x 145 x 330mm



Terrace board, **G3**: 2 of 44 x 145 x 620mm



Terrace board, **G4**: 2 of 44 x 145 x 305mm



Terrace board, **H4**: 2 of 44 x 145 x 897mm



Terrace board, **G2**: 2 of 44 x 145 x 250mm



Terrace board, **G5**: 2 of 44 x 145 x 2274mm



Terrace board, **H2**: 2 of 44 x 145 x 305mm



Terrace board, **H3**: 2 of 44 x 145 x 250mm



Terrace board (half-height),
H1: 1 of 44 x 78 x 897mm



Terrace board (top),
H5: 1 of 44 x 68 x 897mm



Terrace board,
F1: 2 of 44 x 145 x 1500mm



Terrace board,
J1: 2 of 44 x 145 x 1500mm



Terrace fixing board,
T1: 2 of 16 x 145 x 618mm

Terrace capping,
T2: 2 of 33 x 67 x 1500mm

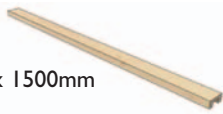

Terrace capping,
T4: 1 of 33 x 67 x 914mm



Terrace board,
J3: 2 of 44 x 145 x 305mm



Terrace board,
F2: 2 of 44 x 145 x 305mm



Terrace board,
J2: 2 of 44 x 145 x 250mm



Terrace board,
F3: 2 of 44 x 145 x 250mm

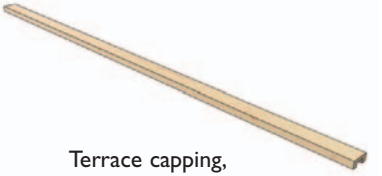

Terrace capping,
T5: 1 of 33 x 67 x 2291mm



Terrace capping,
T3: 2 of 33 x 67 x 688mm



Terrace board (top),
F4: 1 of 44 x 135 x 1500mm



Terrace board (top),
J4: 1 of 44 x 135 x 1500mm



Canopy extension,
EC1: 2 of 68 x 145 x 200mm



Canopy extension,
EC2: 1 of 68 x 145 x 200mm



Canopy extension,
EC3: 1 of 68 x 145 x 200mm



Roof extension,
EC4: 4 of 68 x 145 x 200mm



Ridge extension,
EC5: 4 of 68 x 145 x 200mm



Roof extension,
EC6: 2 of 68 x 145 x 200mm



Canopy wall board (top), **CY3**: 1 of 44 x 142 x 5900mm



Wall board, **D2**: 7 of 44 x 145 x 1825mm



Wall board, **D7**: 6 of 44 x 145 x 479mm



Wall board, **D4**: 6 of 44 x 145 x 385mm



Wall board, **D3**: 7 of 44 x 145 x 2515mm



Wall board, **D5**: 6 of 44 x 145 x 250mm



Wall board, **D6**: 6 of 44 x 145 x 846mm



Wall board, **D9**: 4 of 44 x 145 x 5900mm



Wall board (cut-out), **D1**: 1 of 44 x 145 x 5900mm



Wall board (cut-out), **D8**: 1 of 44 x 145 x 5900mm



Wall board (top), **D10**: 1 of 44 x 91 x 5900mm



Wall board, **B1**: 15 of 44 x 145 x 5900mm



Wall board (top), **B2**: 1 of 44 x 142 x 5900mm



Wall board, **A2**: 8 of 44 x 145 x 3894mm



Wall board, **A3**: 6 of 44 x 145 x 2215mm



Wall board, **A4**: 6 of 44 x 145 x 479mm



Wall board, **A5**: 1 of 44 x 145 x 5394mm



Wall board (half-height), **A1**: 1 of 44 x 78 x 3894mm



Wall board, **C2**: 8 of 44 x 145 x 3894mm



Wall board, **C4**: 6 of 44 x 145 x 2215mm



Wall board, **C3**: 6 of 44 x 145 x 479mm



Wall board, **C5**: 1 of 44 x 145 x 5394mm



Wall board (half-height), **C1**: 1 of 44 x 78 x 3894mm



Wall board, **E2**: 28 of 44 x 145 x 305mm



Wall board, **E3**: 1 of 44 x 145 x 5394mm



Wall board (half-height), **E1**: 1 of 44 x 78 x 3894mm

F.0 building plans

These plans should be used in conjunction with the step-by-step building instructions. The part references refer to components identified in the parts list (see section D.0). All dimensions are in metres (m).

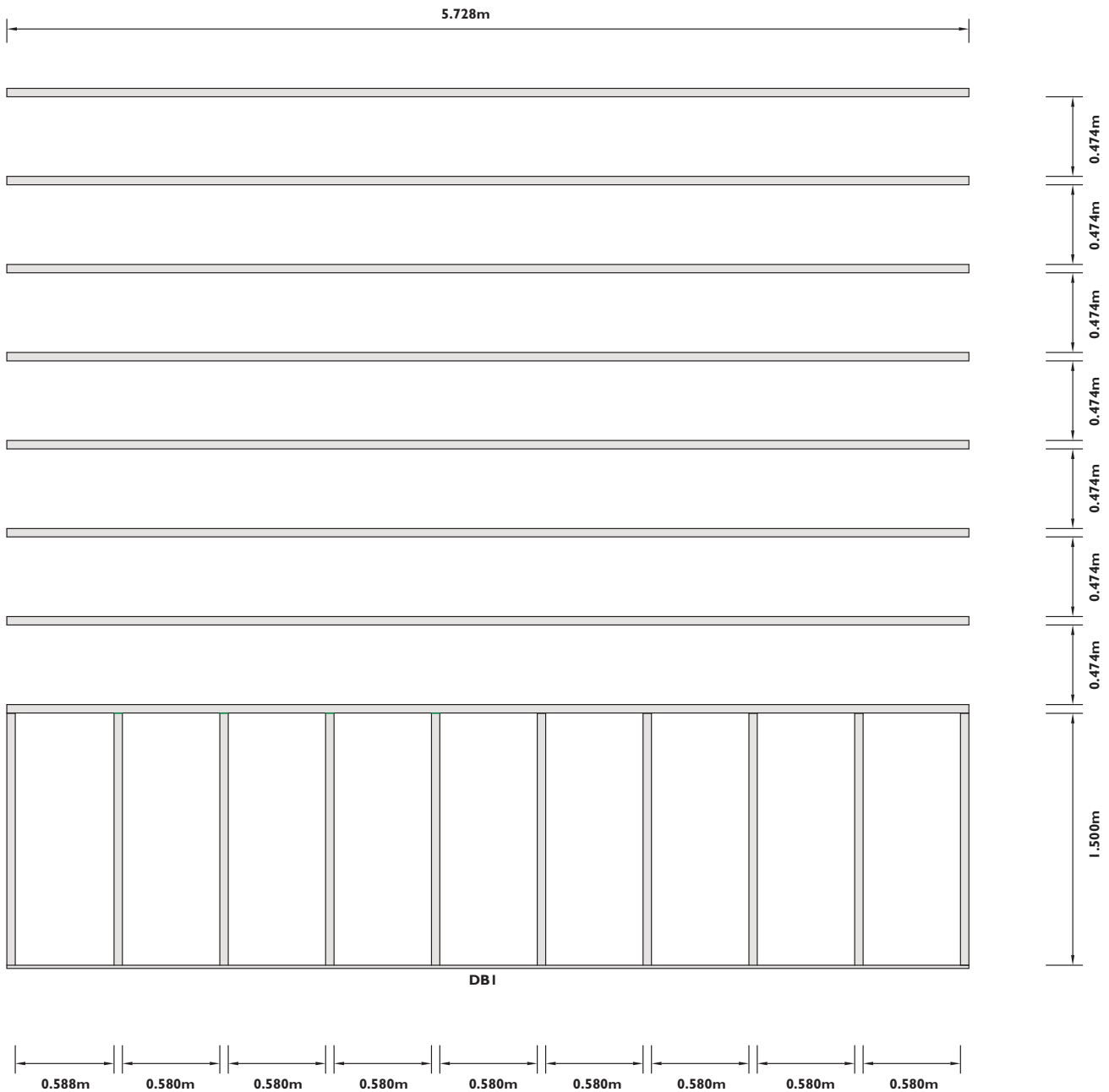

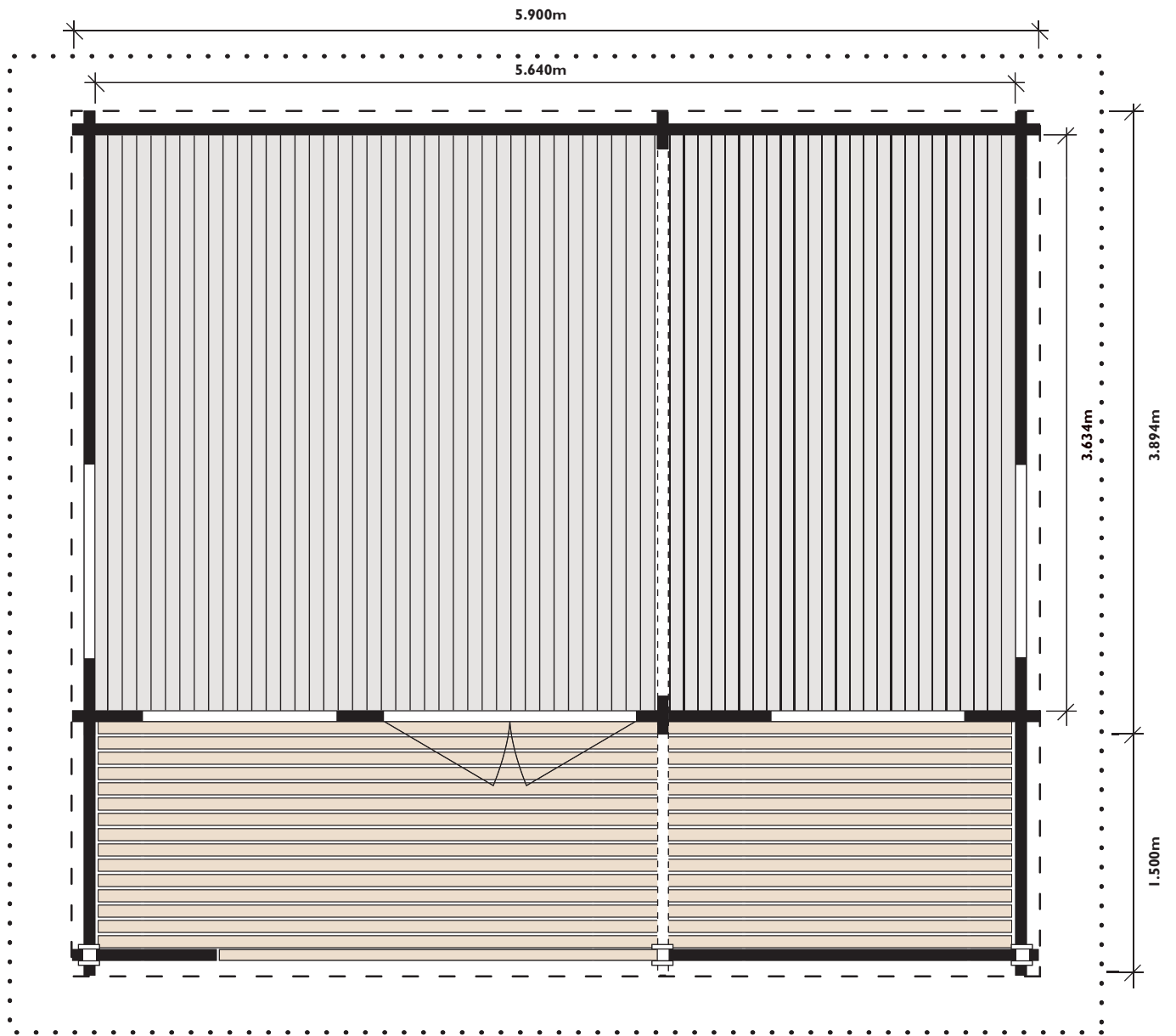

Key

- — — Concrete foundation - this should be made to the same dimensions as the stated floor plan.
- • • • • Compressed gravel - this should be made 300mm larger than the stated floor plan in each direction.

Base sizes shown are a minimum requirement.

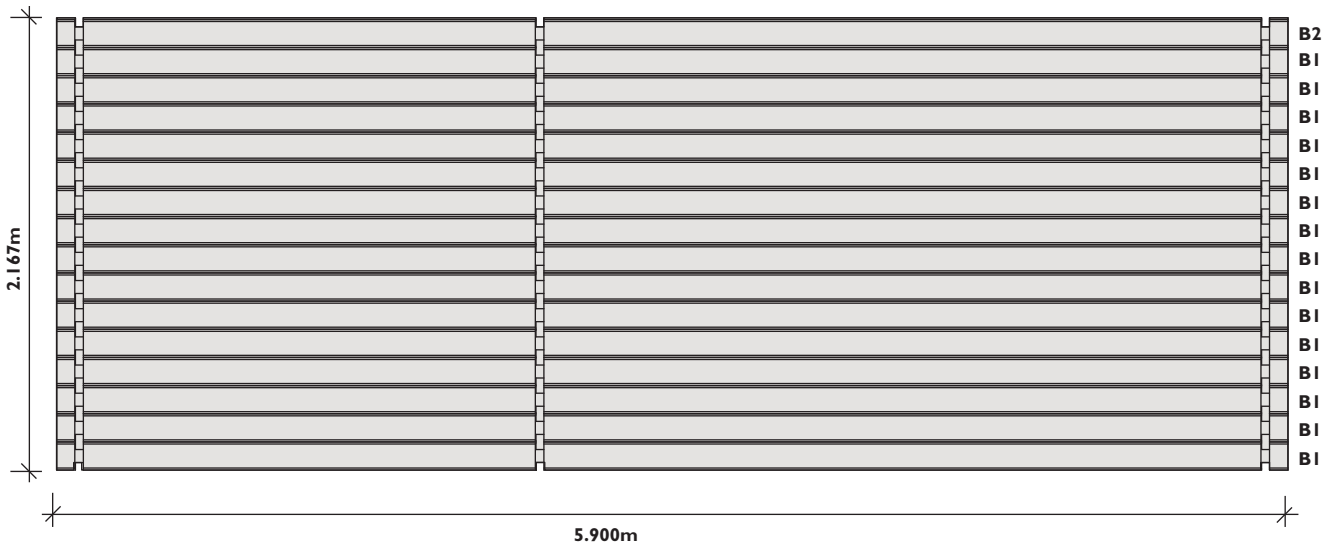
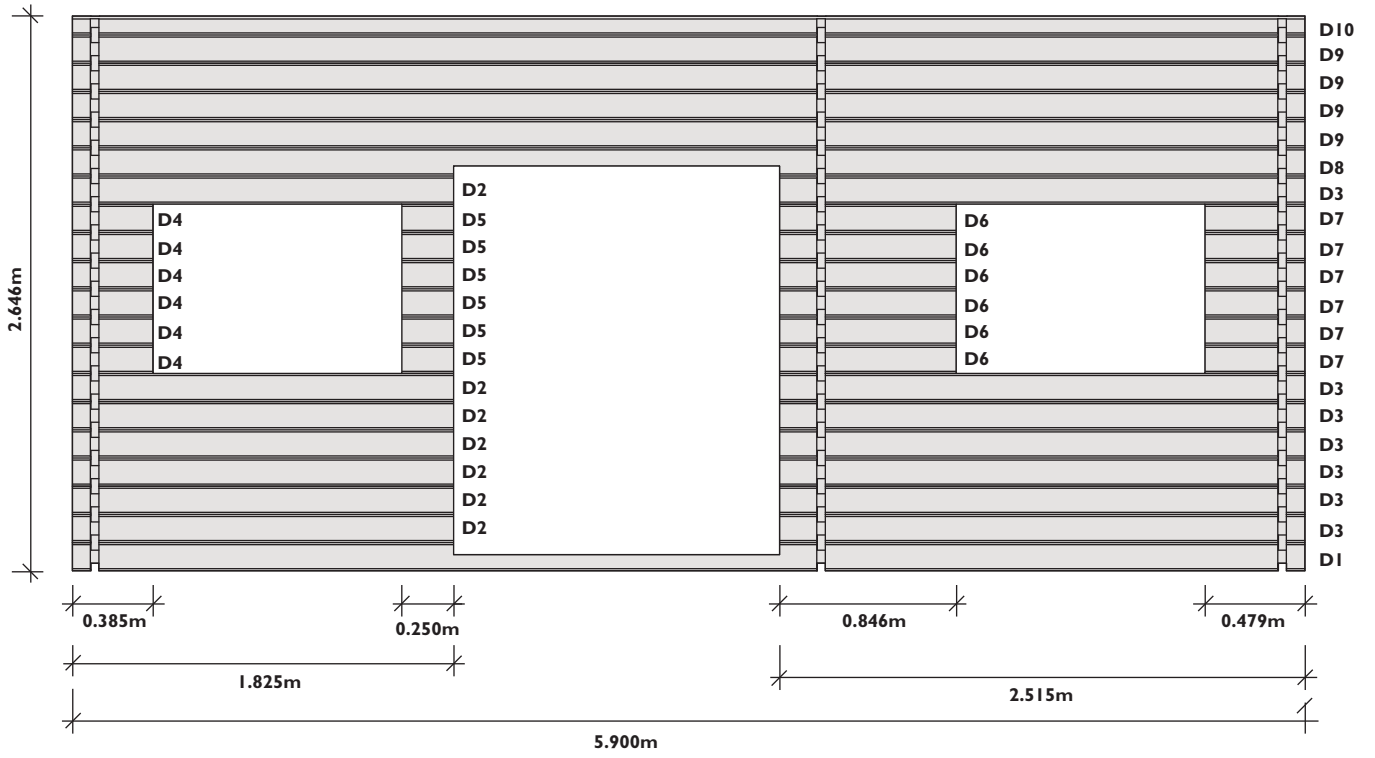

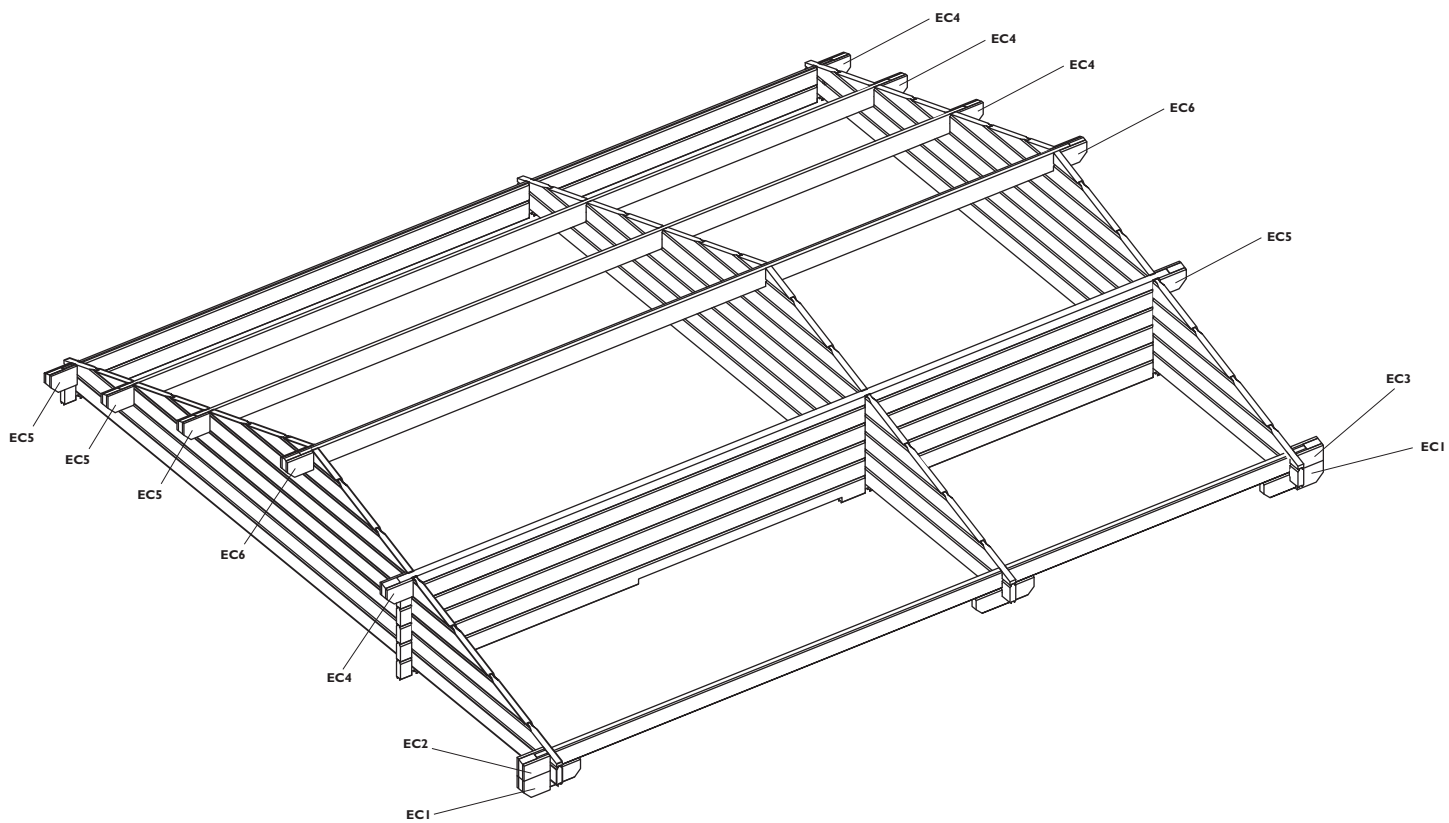

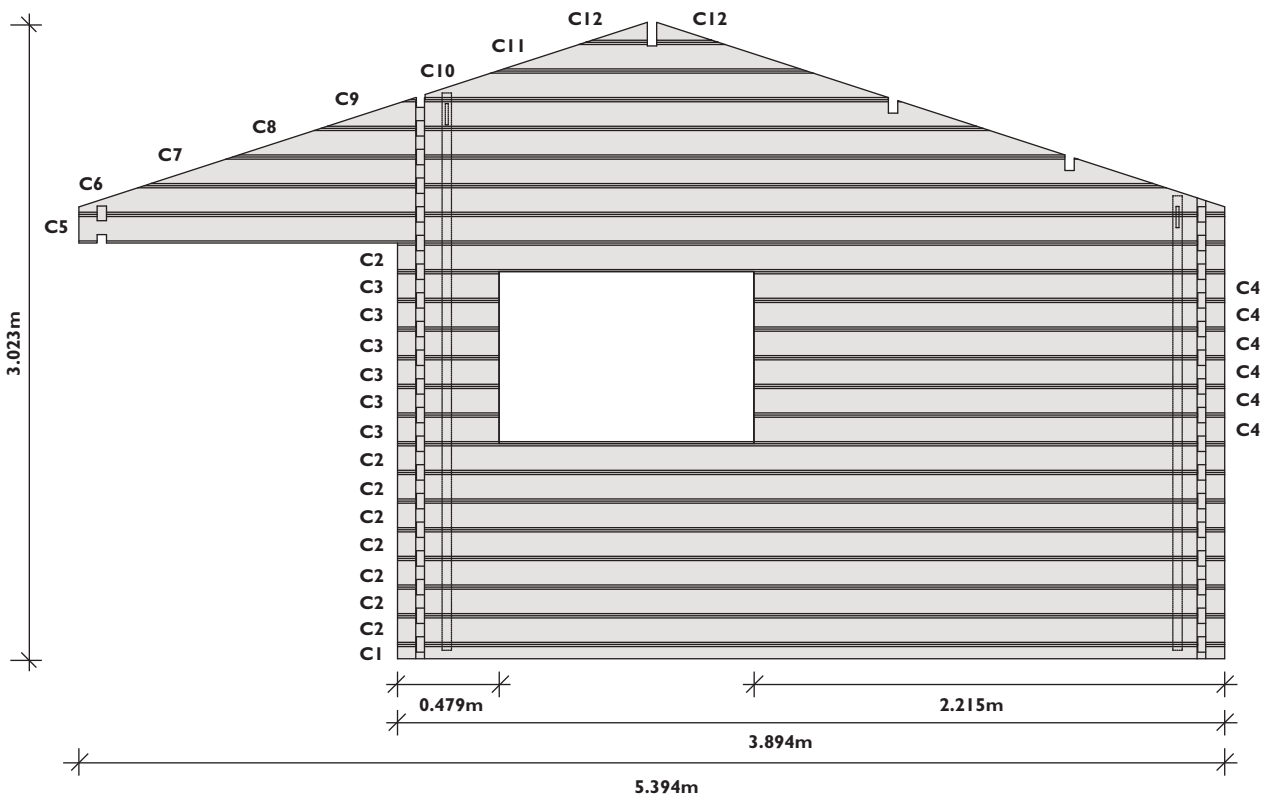
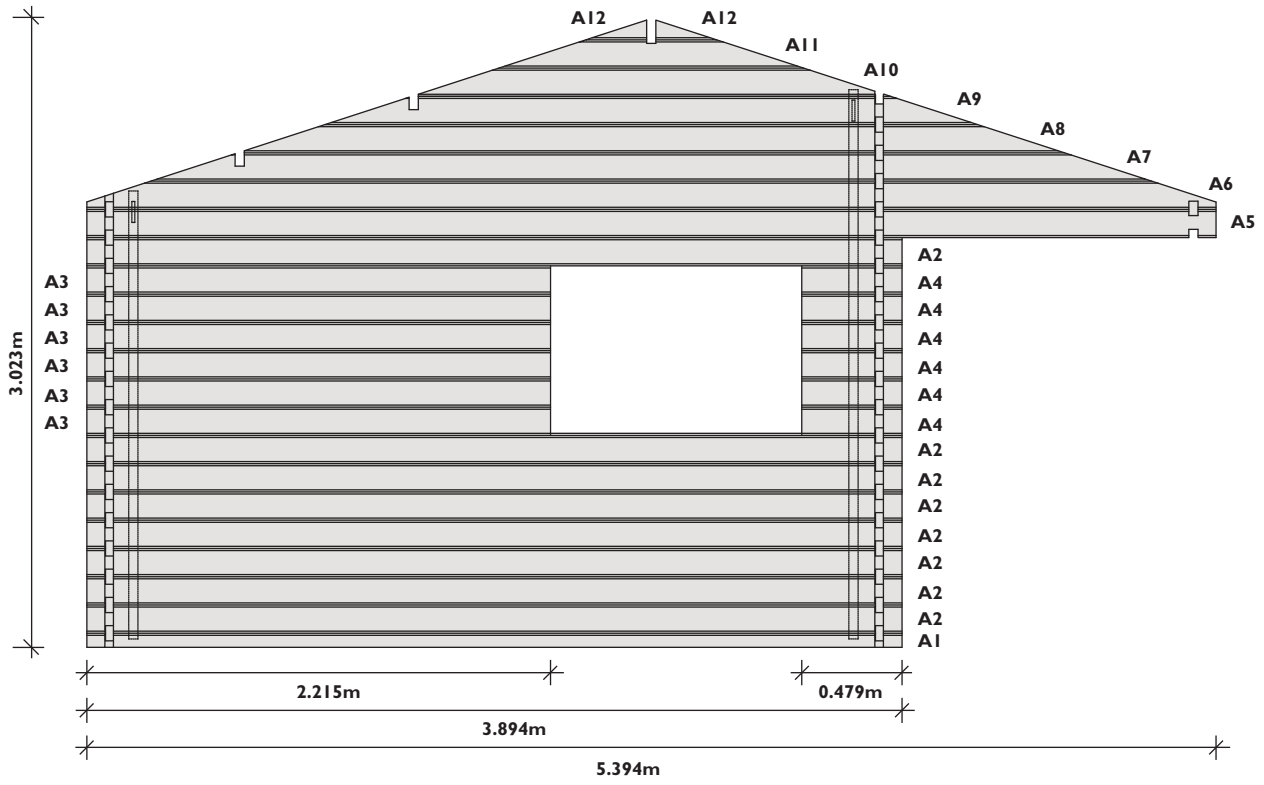

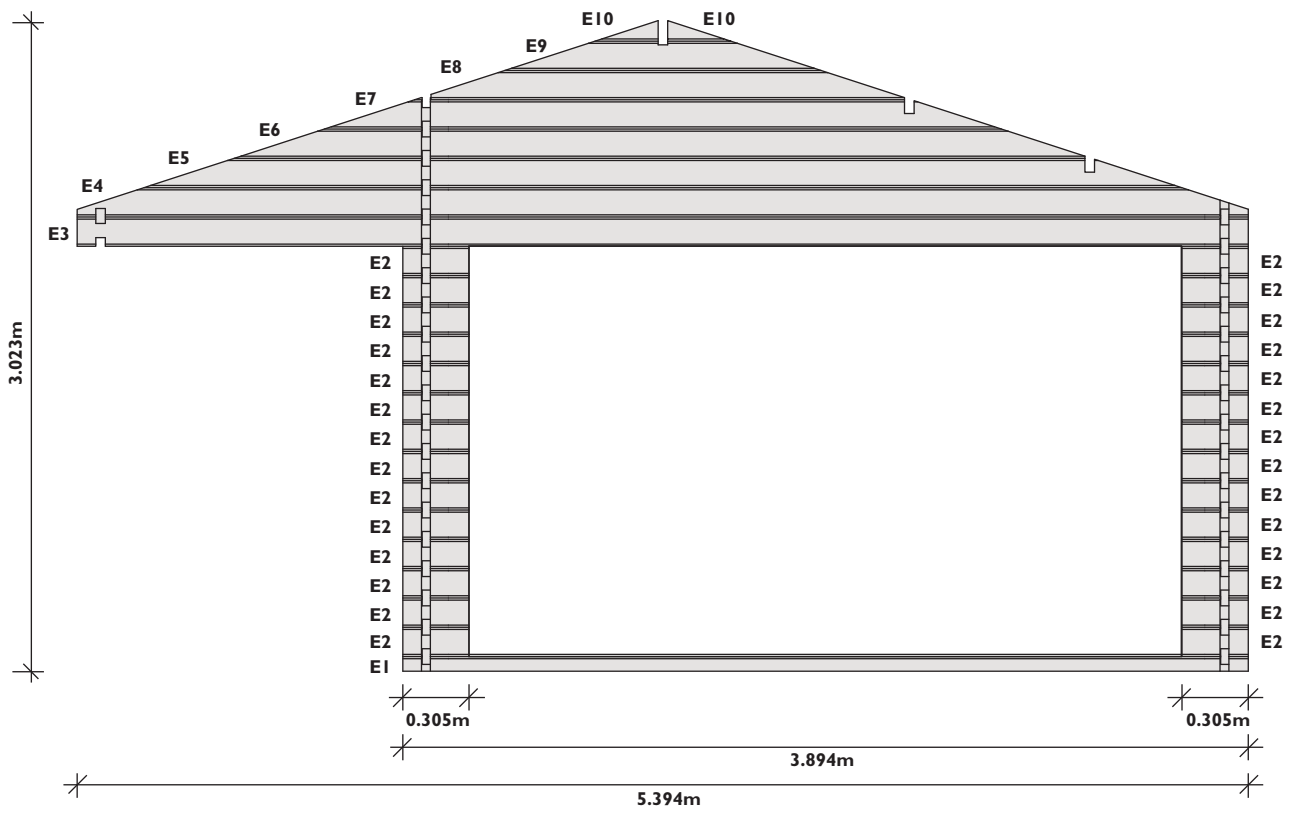



For technical help please refer to the telephone number in your confirmation letter.

Finnlife® is a registered trademark of Finnforest UK.

Wood is the only building material that is truly renewable, if well managed. Forest certification schemes give assurance that the timber is legal and from sustainable sources. Finnforest UK sources certified timber over uncertified and is an approved Chain of Custody supplier.

FF3122 February 2009.

The photographs in this brochure are for illustration purposes only. Finnforest reserves the right to change the range without notice.

finnforest